

# **The Doll House**

## **Facilities:**

Sleeps 1 to 4 people

1 King size bed upstairs

1 Sofa bed in living room

Bathroom

Living room with potbellied gas stove

Kitchen

Gas stove

Refrigerator

Microwave, coffee pot, toaster

Lighted Stone Patio

Gas grill

Fire ring

## **Activities:**

Fishing (Catch and release)(barbless hooks only)

Hiking

Sledding

Ice skating

Target Shooting

Trails for:

Snowmobiling

4-Wheeling

Horseback riding

Paved ½ mile runway for personal aircraft

235 Acres to roam

9 hole executive golf course (see “rental fees” page)

Close to Pine Creek Valley which offers:

Canoeing, rafting, bicycle rails to trails

Close to Lick Run

## **Things to bring:**

Food

(Bedding, towels, soap, and shampoo are provided)

## **Rates**

A \$100.00 deposit is required to reserve your date. (Deposit is non-refundable) (Your deposit will be mailed back to you within 30 days after your stay, unless damage is found to the property. The deposit could also be applied to next year's reservation.) Checks should be made payable to *Ken Hurst* and mailed to *315 Simon Lane, Lock Haven, PA 17745*.

\$100.00 per night for 1 to 2 people.

Each additional person (over 2 people) is \$50.00 per person per night, up to a total of 4 people.

No children between the ages of 6 months to 8 years of age.

Minimum of 2 nights stay.

## **Check In / Out Procedures**

Check in time is any time after 4:00 p.m.

Check out time is 1:00 p.m.

## **Contact Information**

Ken and Marion Hurst

315 Simon Lane

Lock Haven, PA 17745

570-769-2771

[ken.ponderosa@gmail.com](mailto:ken.ponderosa@gmail.com)

[www.ponderosalodgeandgolf.com](http://www.ponderosalodgeandgolf.com)

[www.facebook.com/ponderosaclintoncounty](https://www.facebook.com/ponderosaclintoncounty)

**NO: Hunting, Pets, Smoking, Alcohol, Drugs anywhere on the property.**

(Failure to abide by these rules will forfeit your return deposit.)

## **Policies and Procedures**

Please take time to go over the following guidelines. We ask that you abide by the list of policies and procedures to ensure your safety and well-being as well as the property. Thank you for your cooperation.

The following activities / substances are strictly prohibited anywhere on the property:

~ ***Hunting, Smoking, Alcohol, Drugs. Pets are also prohibited.***

Failure to abide by these rules will result in a fine or loss of deposit.

The Doll House policy prohibits renting to unmarried couples.

No children between the ages of 6 months to 8 years of age.

Please respect all property. Return all property and equipment in the same condition you found it.

Report any broken, damaged or lost items or property to Ken Hurst.

## **Around the grounds:**

Keep within the boundaries of the property.

All barns and equipment are off limits.

Fishing is catch and release. (Barbless hooks)

No Parking / driving or ATVs on the soccer field or golf course.

## **Rules and Regulations for ATVs, Snowmobiles, Motorcycles, Golf Carts, etc.**

Keep ATVs, Snowmobiles, Golf Carts, etc. within the property boundaries.

**Trespassing onto neighboring property is not allowed and will result in a fine.**

A release form **MUST** be signed before riding. This includes both our vehicles and yours if you brought your own.

Riding hours are between 8:00 a.m. and 11:00 p.m.

Ask about special riding hours during the fall hunting season (Oct.-Dec.)

No riding is permitted on the golf course or on the dirt bank directly behind the Lodge. No donuts. No spinning or throwing stones onto the grass or runway in any manner.

No racing on the runway.

Keep speed down on roads that have mowed grass beside them.

## **Clean Up Check List**

Each group is responsible for the following cleanup

- ~ Return all dishes and cooking supplies to their proper place.
- ~ Make final check in all rooms and under the bed to be sure nothing is left behind.
- ~ Pick up all trash inside and outside.
- ~ Turn off all lights.
- ~ Be sure all doors and windows are closed.

## **Rental Fees**

### ATVs and Golf Carts

- \$100.00 per day per vehicle
- \$100.00 deposit per vehicle is required (This will be returned to you after the vehicle is looked over and there is no damage found to both the vehicle and the property. If there is damage, the cost will be deducted from your deposit and/or additional billing if necessary.)
- A release form must be signed before you are permitted to ride
- Renters are responsible for re-fueling each vehicle upon return. All gas used from our gas cans also must be replaced *or*
- There will be a charge of \$4.00 a gallon subtracted from your deposit for any gas we have to replace.

### Enduro Motorcycles

- Same rental fees and regulations as for ATVs and golf carts.
- For off-property touring only.
- Current motorcycle license is required.

### Property Usage Charge

- If you are bringing ATVs, motorcycles, snowmobiles, etc. onto the property, there is a flat rate charge of \$20.00 per vehicle for a weekend (Friday-Sunday) and / or \$40.00 per vehicle for a week (Sunday-Friday). All riding regulations still apply.

### Kayaks, Canoes, Paddle Boats

- \$10.00 per hour per boat

## **9 Hole Executive Golf Course**

- Advanced notice is recommended if you would like to golf.
- \$15.00 per person per game
- \$25.00 per person unlimited golf for a 1 day pass
- Golf cart for rent at \$15.00 per game (to be returned after each game) □ Club sets available for rent at \$5.00 per set per game. □ New balls \$5.00 each / Used balls \$1.00 each



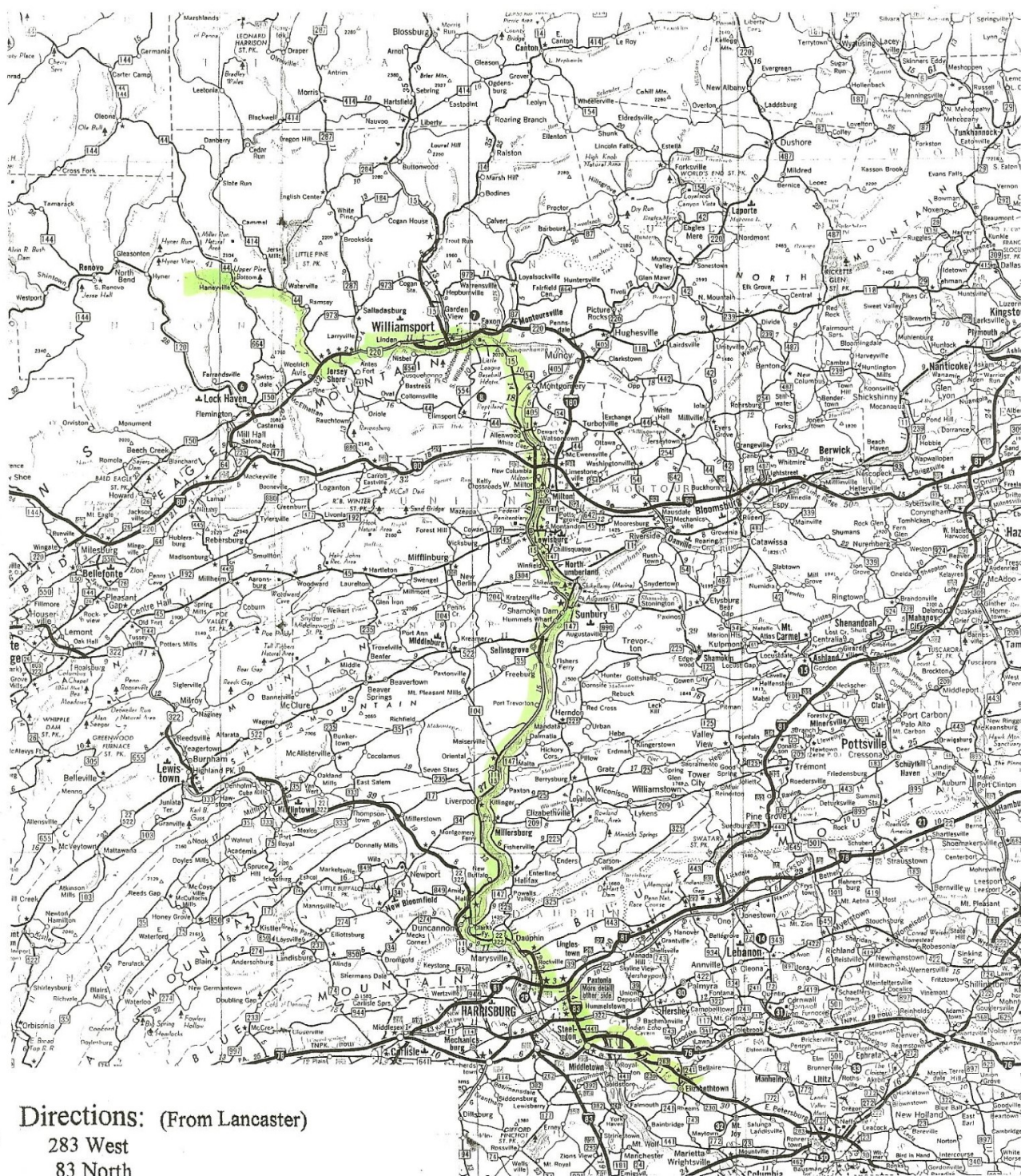

### Directions: (From Lancaster)

- 283 West
- 83 North
- 322 West (take across the river)
- 11 – 15 North
- 15 North
- 220 South (at Williamsport)
- 44 North to Stop sign (44 & 664 will intersect)
- Turn Right. Go 100 yards and turn
- Left on Carrier Road
- Right on Ponderosa Drive
- Right on Simon Lane

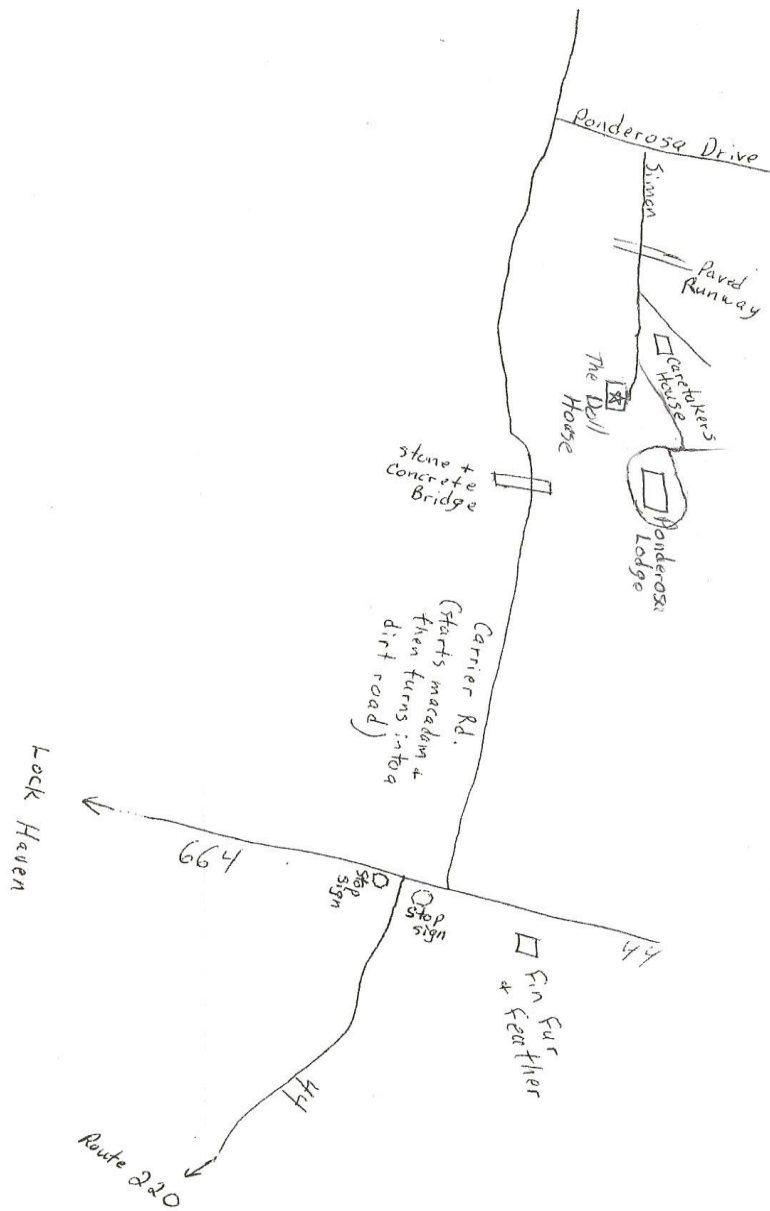



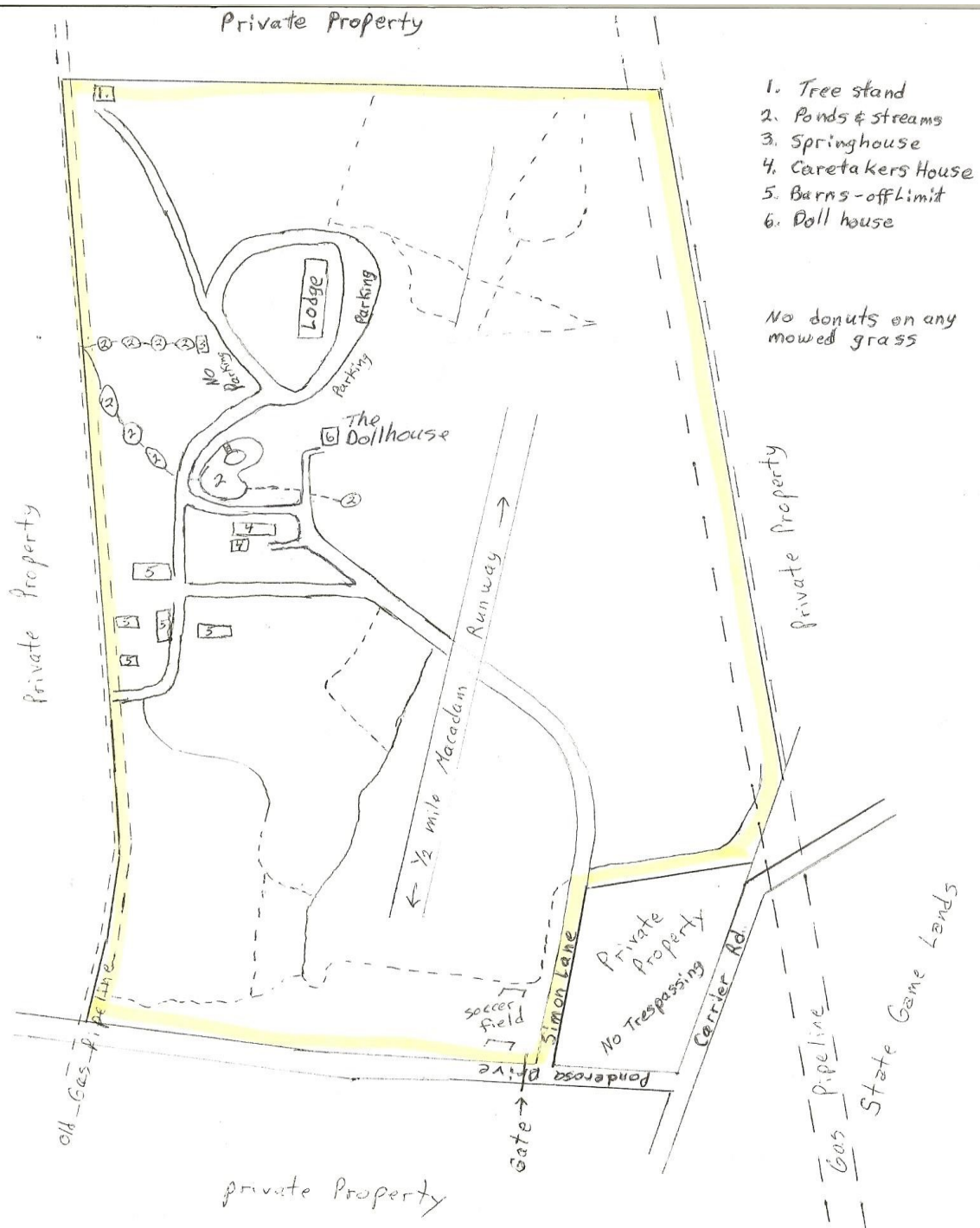

**Release Form:**

I \_\_\_\_\_,

Hereby assume the responsibility for \_\_\_\_\_.  
(Group Name)

I assume and take on myself the risk and responsibilities associated with activities at the Ponderosa Lodge including but not limited to the following:

*Use of ATVs, Snowmobiles, Motorcycles, Golf, Sledding, Ice Skating, Swimming, Fishing, shooting, boating, etc.*

I agree to exercise prudence and reasonable care while participating in all activities.

I understand and agree that The Ponderosa Lodge and /or Kenneth & Marion Hurst assume no responsibility for any injury or damage caused by our activities.

I agree to keep all motor vehicles off of the neighboring properties. I understand that a fine will be charged if I, or others in my group, do not abide by this rule. (This does not apply to the usage of State designated trails for ATVs and snowmobiles.)

I agree to the following regulations:

No riding is permitted between the hours of 11:00 p.m. and 8:00 a.m.

Ask about special riding hours during fall hunting season (Oct. – Dec.)

No riding is permitted on the golf course or on the dirt bank directly behind the Lodge.

No donuts. No spinning or throwing stones onto the grass or runway in any manner.

No racing on the runway.

**Only 4-wheelers, ATVs and motorcycles with stock exhaust systems will be allowed.**

***Failure to abide by any or all of these rules will forfeit your deposit.***

Participant's Signature: \_\_\_\_\_

Date: \_\_\_\_\_

-----  
**If renting ATVs, golf carts or motorcycles from the Ponderosa Lodge, please review and sign the following also:**

To rent ATVs or golf carts the operators must be 16 years of age or older. To rent motorcycles, a current motorcycle license is required.

We hope you have a good time using our ATVs / golf carts / cycles. We ask that you return them in the same condition you received them. Failure to do so will result in a deduction from your deposit and / or additional billing if necessary. We reserve the right to take away the keys if we see it is necessary to ensure the safety of our guests and our property.

Signature: \_\_\_\_\_

Date: \_\_\_\_\_



# *The Dollhouse Settlement Sheet*

Name: \_\_\_\_\_

Phone #: \_\_\_\_\_

Date of Visit: \_\_\_\_\_

Please enclose this sheet with payment

Please make your check payable to:

**Kenneth Hurst**

315 Simon Lane

Lock Haven, PA 17745

570-769-2771

Description	Rate	Charge
Number of Nights:	\$100.00 per night (up to 2 people)	
Number of additional people: Number of nights:	\$ 50.00 per night (each additional person)	
Lodging Subtotal		
Hotel Tax 5%		
Sales Tax 6%		
Lodging Total		

Description	Rental/Service Fee	Charge
Boat Rental	\$ 10.00 per hour per boat	
ATV/Golf Cart Rental (requires an additional \$100.00 deposit per vehicle)	\$100.00 per vehicle per day	
-Gasoline	\$ 4.00 per gallon	
Property Use Charge (for ATVs, motorcycles, snowmobiles, etc.)	\$ 20.00 per vehicle (weekend (Fri.-Sun.))	
	\$ 40.00 per vehicle (week Sun.-Fri.)	
Golf	\$ 15.00 per person per game <i>or</i> \$ 25.00 / person unlimited 1 day pass	
Golf cart rental (for golfing)	\$ 15.00 per game (return after each game)	
Golf clubs	\$ 5.00 per set per game	
Golf balls	\$ 5.00 each new / \$ 1.00 each used	
Rental Fees Subtotal		
Sales Tax 6%		
Rental Fees Total		

Lodging Total	
Rental Fees Total	
TOTAL	

Comments and / or Suggestions: